

10 Dallas Court Hallam, Victoria 3803  
ABN 27 106 103 315  
[www.aggdoors.com.au](http://www.aggdoors.com.au)  
[enquiries@aggdoors.com.au](mailto:enquiries@aggdoors.com.au)  
(03) 8789 1385

## Remote Code Set Procedure (PTX-4)

If a transmitter is already coded into the opener, additional transmitters can be coded without being in direct contact with the opener's control panel.

**NOTE:** Only the function of the existing transmitter button can be assigned to new transmitter. Please read instructions prior to proceeding - there is a time-out facility for security reasons.

### 1. Selecting the function to be coded

Using the existing transmitter, operate the gate with the transmitter button which has the function to be coded (**Fig. 45**) (e.g. Button 1 has been coded with the OSC function assigned).

### 2. Wait for gate to complete cycle

If the button's function activates the gate (PED, SWP, OSC, CLS, STP or OPN) wait for the gate to complete its cycle.

### 3. Activate remote code set mode

Using a small pin press and hold through the Coding Hole of the existing transmitter for two seconds (**Fig. 46**).

### 4. Code new transmitter button

Within 10 seconds, press the button on the new transmitter you wish to code for 2 seconds (**Fig. 47**).

### 5. Confirm transmitter button to be coded

Press the same button again (within 10 seconds) for confirmation.

### 6. Test operation

The new transmitter button should now function as the existing transmitter.

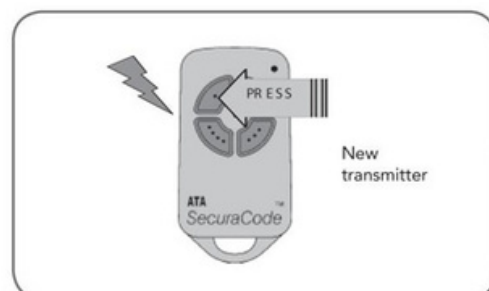
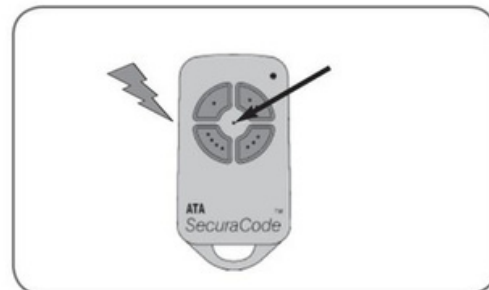
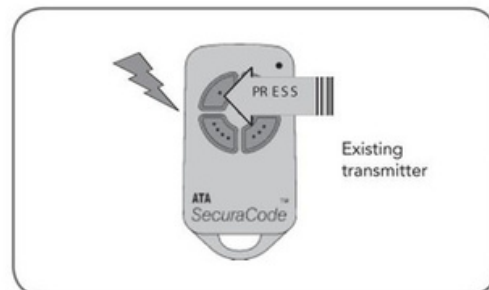

## Remote Code Set Procedure (PTX-5)

If a transmitter is already coded into the opener, additional transmitters can be coded without being in direct contact with the gate opener.

**NOTE:** Only the function of the existing transmitter button can be assigned to a new transmitter. Please read instructions prior to proceeding - there is a time-out facility for security reasons.

### 1. Selecting the function to be coded

Using the existing transmitter, operate the gate with the transmitter button which has the function to be coded (**Fig. 43**) (e.g. Button 1 has been coded with the OSC function assigned).

### 2. Wait for gate to complete cycle

If the button's function activates the gate (PED, SWP, OSC, CLS, STP or OPN) wait for the gate to complete the cycle.

### 3. Activate remote code set mode

Using a small pin, press and hold through the Coding Hole of the existing transmitter for two seconds (**Fig. 44**).

### 4. Code new transmitter button

Within 10 seconds, press the button on the new transmitter you wish to code for 2 seconds (**Fig. 45**).

### 5. Confirm transmitter button to be coded

Press the same button again (within 10 seconds) for confirmation.

### 6. Test operation

The new transmitter button should now function the same as the existing transmitter.

**NOTE:** When a transmitter is remote coded, its ID label is set to that of the existing transmitter. If the existing transmitter does not have an ID label assigned, then the ID label of the new transmitter is set to: R/C Tx ###, where ### is the existing transmitters store number. This ensures that the originator of any remote coded transmitter can be identified.

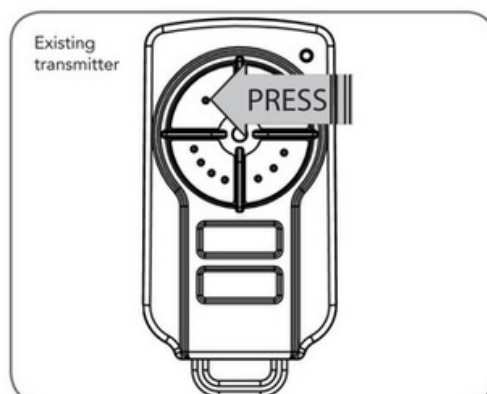

fig 43

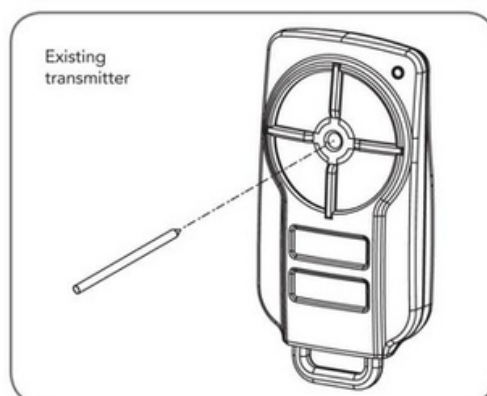

fig 44

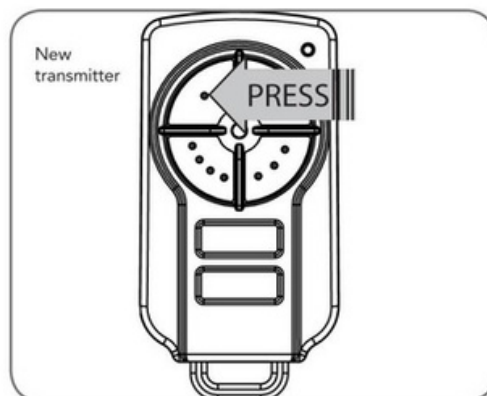

fig 45